

Slow Combat One Design Wing

Wing made from $\frac{1}{4}$ " blue foam.
CG $1\frac{3}{4}$ " to $2\frac{1}{2}$ " behind leading edge
KFm2 airfoil
Wing 48" X 11.5" (including 1.5" elevons)
Elevons may be balsa or blue foam
Using factory fold for leading edge

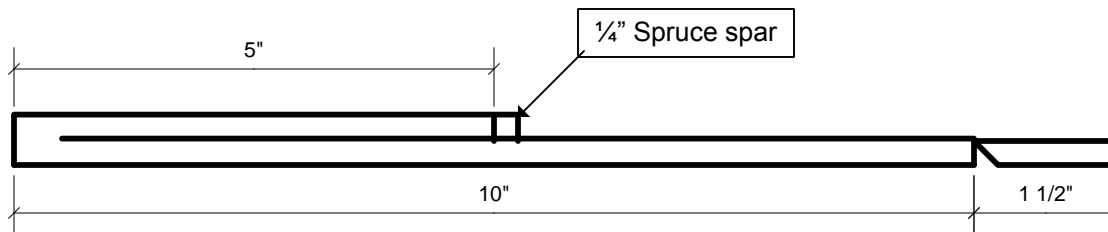

Option 1 wing – spar behind top surface

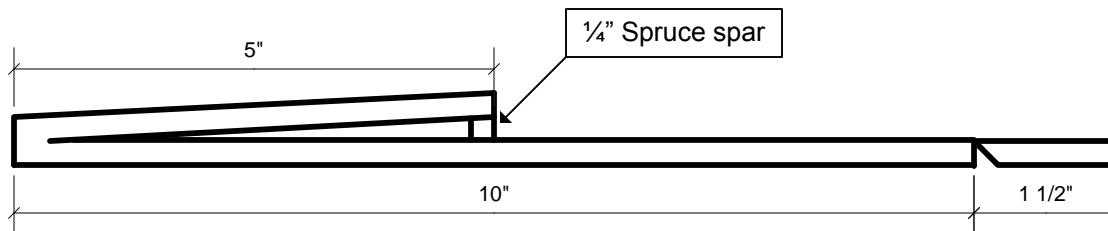

Option 2 wing – spar between surfaces

All dimensions in inches
Scale 1"=2"

5/11/2011