

Super
Tigre

ST 60 R/C W/M

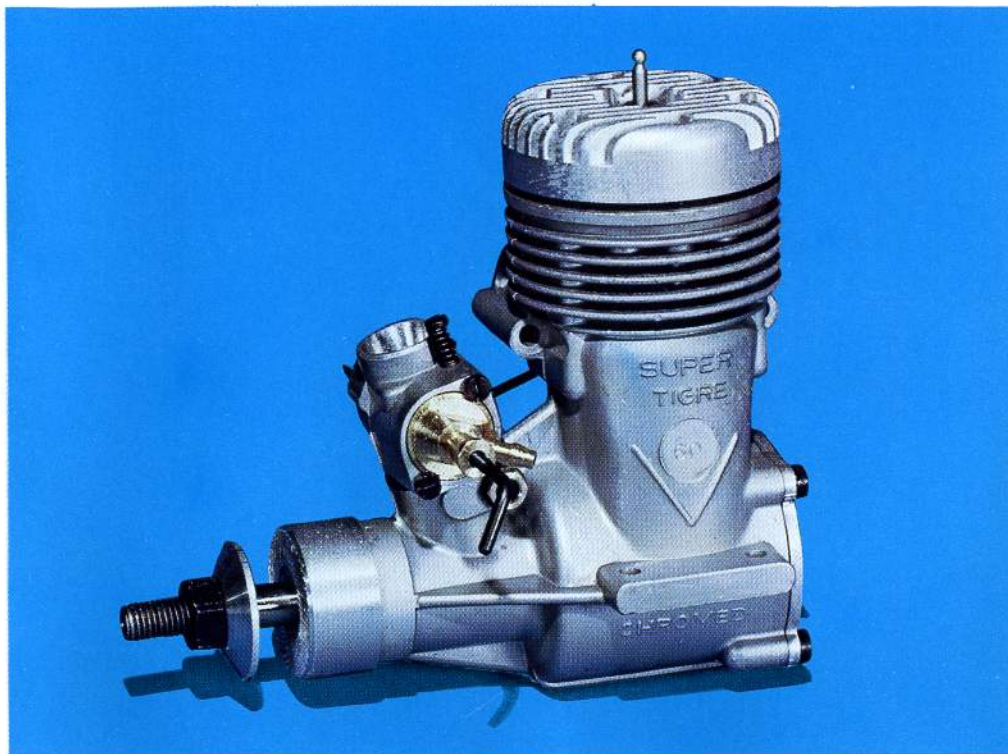

ST 60 R/C W/M

cod. 11001809

Corsa	mm.	22	Stroke	.866 in.
Alesaggio	mm.	24	Bore	.945 in.
Cilindrata	cc.	9,95	Displacement	.607 cu. in.
Potenza	HP	1,38	Power	1.38 HP
a 13800 giri al 1'			at 13800 RPM	
Peso	gr.	400	Weight	17.3/4 oz.

CAMICIA IN ACCIAIO
PISTONE MONOSEGMENTO

STEEL SLEEVE
SINGLE RING PISTON

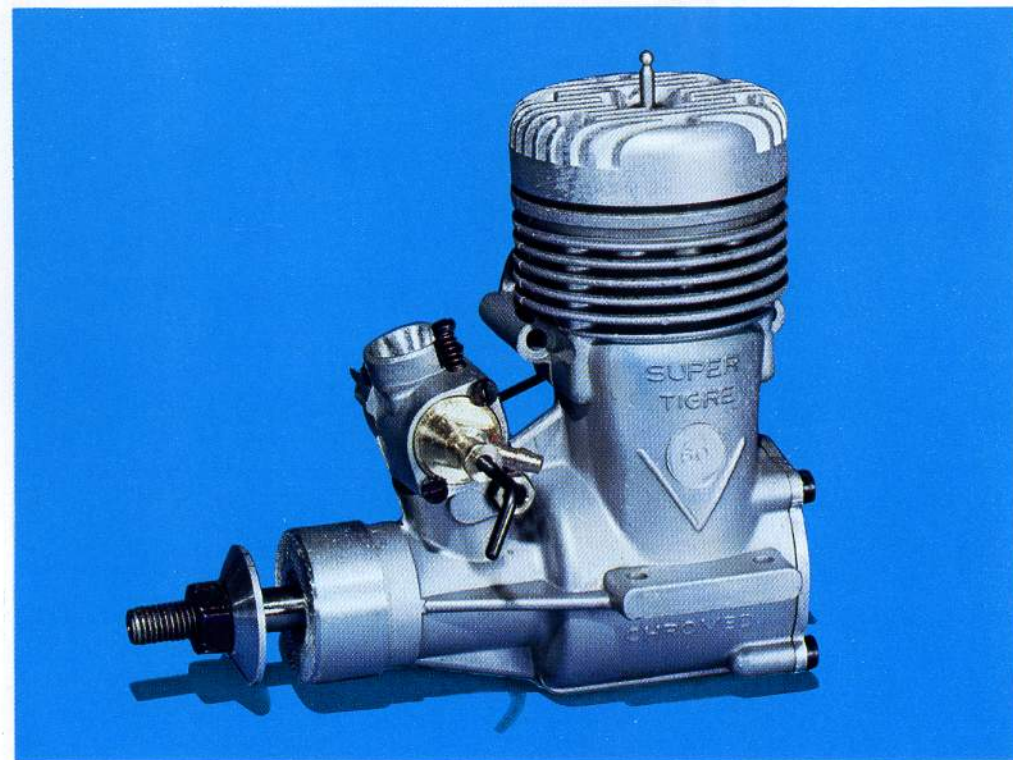

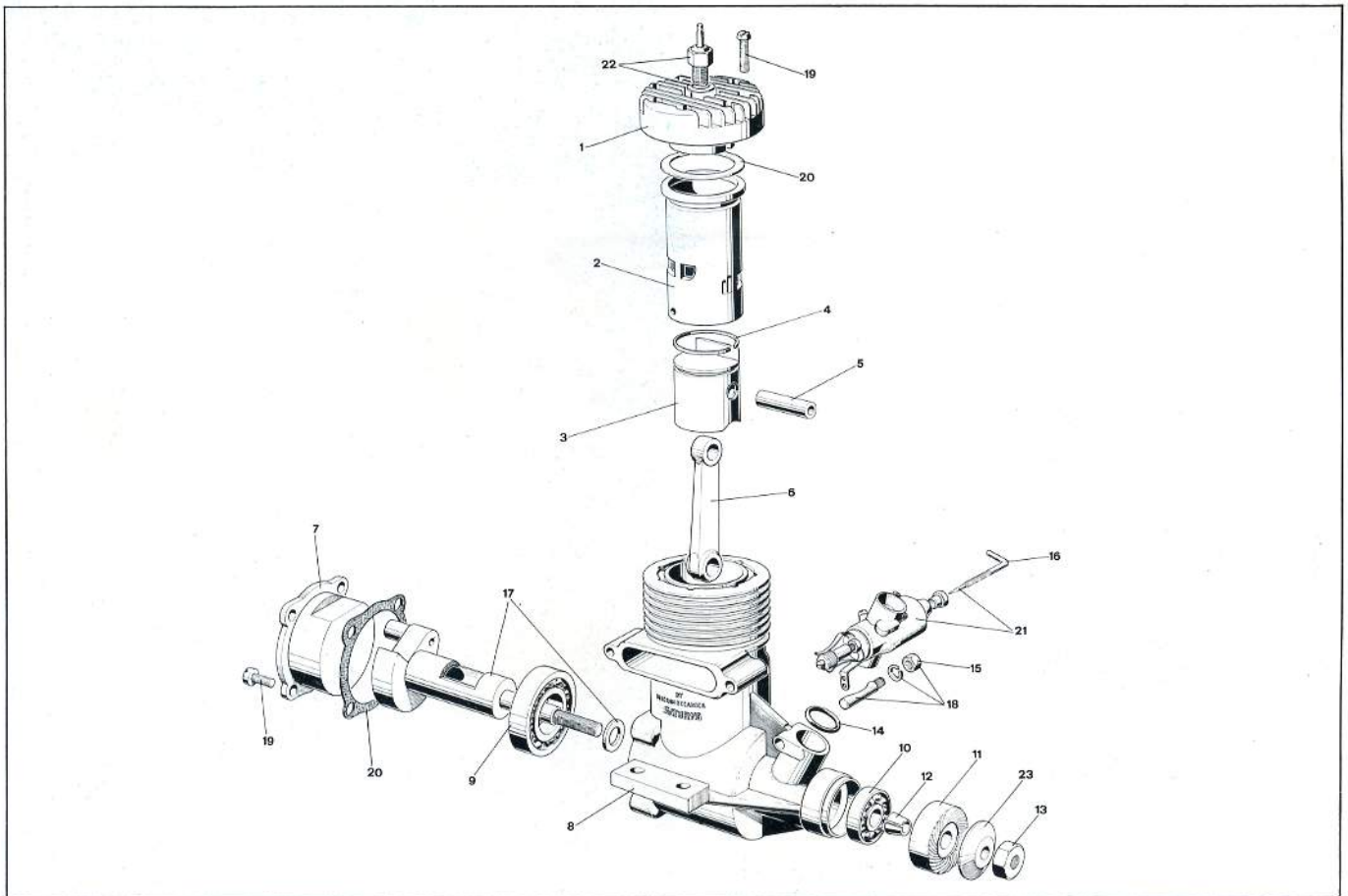

ST 60 R/C W/M

1) Testa	Head	02290393
2) Camicia	Sleeve	02041438
3) Pistone	Piston	02200281
4) Segmento	Ring	02230318
5) Spinotto	Wrist pin.	02270261
6) Biella	Conrod.	02031806
7) Tappo post.	Backplate	02280372
8) Carter	Crankcase	02051808
9) Cusc. post.	Rear ball bearing	02120242
10) Cusc. ant.	Front. ball bearing	02120238
11) Rondella trasc.	Rear drive washer	02221058
12) Cono blocc.	Lock. cone	02100234
13) Dado albero	Prop. nut.	02110245
14) OR. 2050	OR. 2050	02020562
15) Dado carb.	Spray bar nut.	02110247
16) Spillo	Needle	02260353
17) Albero	Crankshaft	22011807
18) Chiavetta blocc.	Retainer	22080212
19) Serie viti	Screw. set.	22250342
20) Serie guarn.	Gasket. set.	22240331
21) MAG V	MAG V	12161139
22) Candela K.W.	Glow plug. K.W.	12061148
22) Candela R/C	Glow plug. R/C	12060589
23) Rondella blocc.	Front. washer	02220291
24) Silenziatore	Muffler	12520929