

◀ **G 21/46**

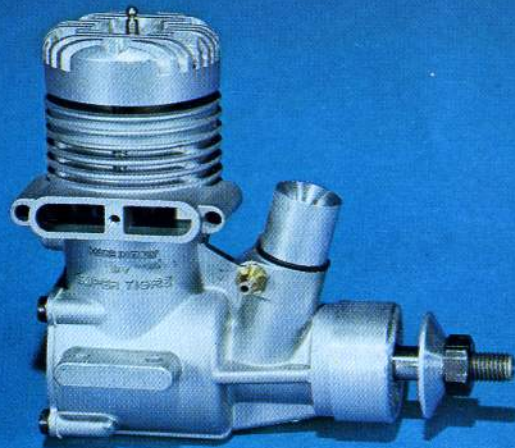

Corsa	m/m	19,80	Stroke	.779
Alesaggio	m/m	22	Bore	.866
Cilindrata	c.c.	7,5	Displacement	.459 cu.in.
Peso	g.	255	Weight	9 oz.
Potenza	HP	0,72	Power	.72 HP
		a 13.000 giri al 1'		at 13.000 RPM

2 CUSCINETTI A SFERA SULL'ALBERO
PISTONE MONOSEGMENTO
CAMICIA CROMATA
PER VOLO VINCOLATO

TWO BALL BRG. IN CRANKSHAFT
SINGLE RING PISTON
CHROME PLATED SLEEVE
FOR CONTROL LINE STUNT

G 21/46 R/C ▶

Corsa	m/m	19,80	Stroke	.779
Alesaggio	m/m	22	Bore	.866
Cilindrata	c.c.	7,5	Displacement	.459
Peso	g.	275	Weight	9 3/4 oz.
Potenza	HP	0,85	Power	.85 HP
		a 15.000 giri al 1'		at 15.000 RPM

2 CUSCINETTI A SFERA SULL'ALBERO
PISTONE MONOSEGMENTO
COMANDO R/C: MAG IV
PER RADIO COMANDO
CAMICIA CROMATA

TWO BALL BRG. IN CRANKSHAFT
SINGLE RING PISTON
MAG IV R/C THROTTLE
FOR R/C STUNT
CHROME PLATED SLEEVE

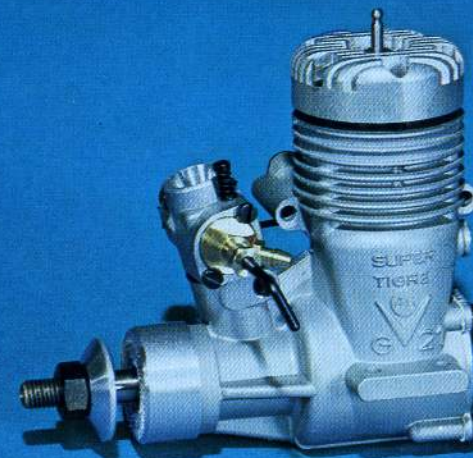

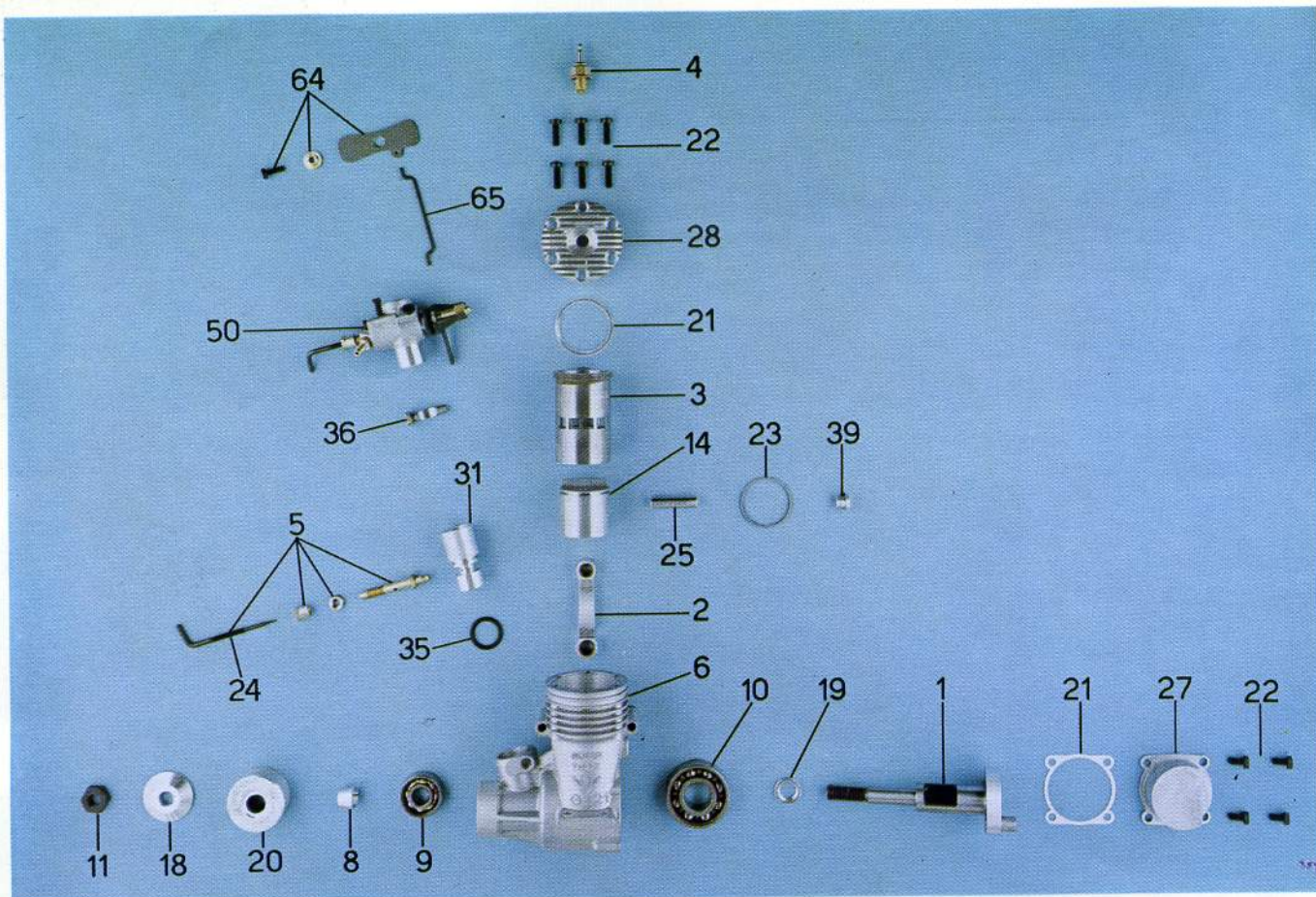

G. 21/46

- 1) Albero
- 2) Biella
- 3) Camicia
- 4) Candela
- 5) Carb. completo
- 6) Carter
- 8) Cono di blocc.
- 9) Cuscinetto ant.
- 10) Cuscinetto post.
- 11) Dado albero
- 14) Pistone
- 18) Rondella di blocc.
- 19) Rondella dist. albero
- 20) Rondella di trasc.
- 21) Serie guarnizioni
- 22) Serie viti
- 23) Segmento
- 24) Spillo carb.
- 25) Spinotto
- 27) Tappo carter
- 28) Testa
- 31) Venturi STD
- 35) Anello di gomma
- 36) Chiavetta di blocc.
- 39) Vite spinotto
- 50) Mag. completo
- 64) Scarico completo
- 65) Filo di colleg.

- Crankshaft
- Conrod
- Sleeve
- Glow plug
- N.V. assembly
- Crankcase
- Lock cone
- Front ball brg.
- Rear ball brg.
- Prop nut
- Piston
- Front washer
- All. washer
- Rear drive washer
- Gasket set
- Screw set
- Single ring
- Needle valve
- Wrist pin
- Back plate
- Cylinder head
- STD Venturi
- Rubber ring
- Retainer
- Wrist pin screw
- Complete mag.
- Exhaust package
- Cable connection

STD

2010075
 G 40/10 N
 2040477
 A 15/23
 AA 29/18
 2050523
 AA 29/1
 AA 29/5
 AA 29/6
 AA 29/2
 AA 46/12
 AA 29/3
 B 29/4/2
 AA 29/4 B
 AA 46/4
 AA 46/5
 AA 46/13
 A 15/17
 AA 46/3
 CA 35/3
 1551
 2320590
 2020561
 —
 1386
 —
 —
 —

R/C

2010075
 G 40/10 N
 2040477
 1661
 —
 2050523
 AA 29/1
 AA 29/5
 AA 29/6
 AA 29/2
 AA 46/12
 AA 29/3
 B 29/4/2
 AA 29/4 B
 AA 46/4
 AA 46/5
 AA 46/13
 —
 AA 46/3
 CA 35/3
 1551
 —
 2020561
 BB 35/8/4
 1386
 2160536
 2490672
 1459